

DRAFT: FOR DISCUSSION PURPOSES ONLY

IMPORTANT NOTE: ACREAGE VALUES AND OWNERSHIP HEREIN ARE DERIVED FROM HISTORICAL AND CURRENT RECORDS LOCATED AT THE DANE COUNTY DEPARTMENT OF PLANNING AND DEVELOPMENT (EG. GIS, PLAT BOOKS, ZONING PERMIT DATA, CSM'S, ETC). DENSITY POLICIES VARY AMONG TOWNS AND MAY REQUIRE INTERPRETATION.

Applicant: Alice Berlow

Town	Primrose	A-1EX Adoption	12/16/1985	Orig Farm Owner	Gartzke, P.C.
Section:	27	Density Number	35	Original Farm Acres	16.97
Density Study Date	4/26/2023	Original Splits	0.48	Available Density Unit(s)	1

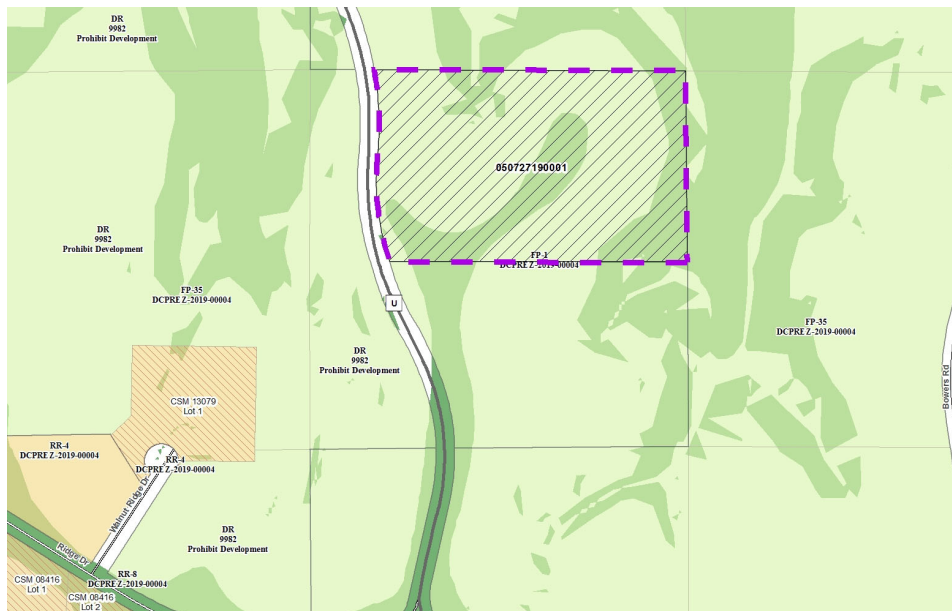

Reasons/Notes:

Property was legally created as a separate, legal parcel of record prior to April 28, 1981. The town/county plan allows such parcels no more than one building site.

Note: Parcels included in the density study reflect farm ownership and acreage as of the date of town plan adoption, or other date specified. Density study is based on the original farm acreage, NOT acreage currently owned.

Parcel #	Acres	Owner Name	CSM
050727190001	16.93	ALICE J BERLOW	